

Note: Detail drawing for reference only.
METROBRICK Architectural Thin Brick should be installed according to the Tile Council of North America Standards, ANSI standards and local building codes. Use only reputable installers and the correct installation products to suite the application

3 Dimensional view

©2008 METROBRICK

Note: Vapor Barrier and Insulation
Type/Location to be Determined
by Design Professional

METROBRICK Modular Size

Grout

Thinset

Waterproofing Membrane

Sheathing

Sub Structure

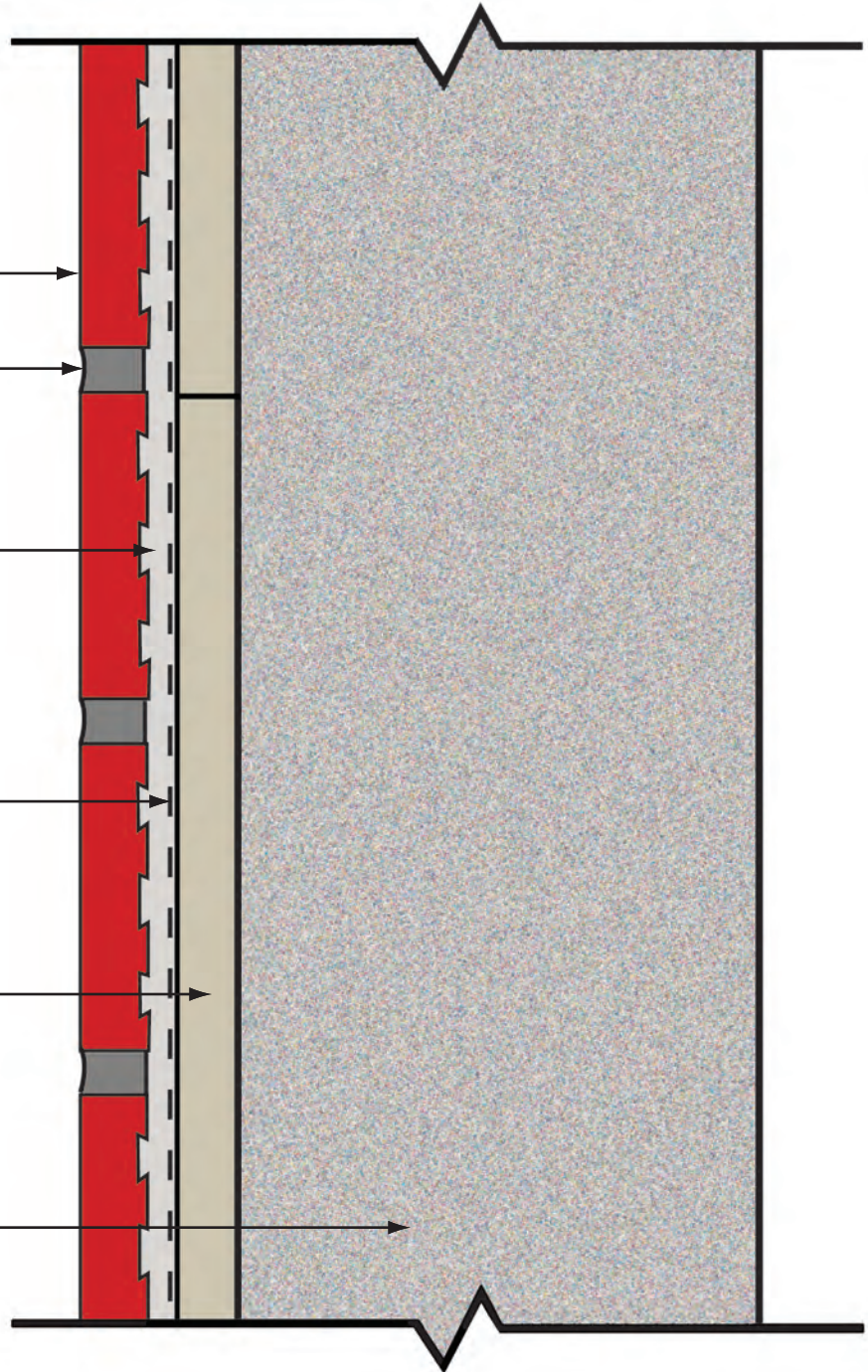

Note: Detail drawing for reference only.
METROBRICK Architectural Thin Brick should be installed according to the Tile Council of
North America Standards, ANSI standards and local building codes. Use only reputable
installers and the correct installation products to suite the application. METROBRICK
accepts no liability for the end use of this detail.

Scale: 3/4

©2008 METROBRICK[®]